

LOADING PATTERN MATING SIDE

f	6	6	6	6	6	6	6	6	6	6			6	6	6	6	6	6	6	6	6	6	6	6	6	6	
e	A	A	G	A	G	A	G	A	G	7	G		7	G	7	7	7	7	7	7	7	7	7	7	7	7	
d	A	G	A	G	A	G	A	G	7	G	7		G	7	7	7	7	7	7	7	7	7	7	7	7	7	
c	G	G	G	A	G	G	A	G	G	7	G		7	G	7	7	7	7	7	7	7	7	7	7	7	7	
b	A	A	A	A	7	A	7	A	7	A	7		A	7	7	7	7	7	7	7	7	7	7	7	7	7	
a	G	G	7	7	G	7	7	G	G	7	G		7	G	7	7	7	7	7	7	7	7	7	7	7	7	
z	6	6	6	6	6	6	6	6	6	6	6		6	6	6	6	6	6	6	6	6	6	6	6	6	6	
P																											
S	0				0					1			1									2				2	
	1				5					0			5									0				5	

LOADED CONNECTOR ASSEMBLY (FOR EXAMPLE)

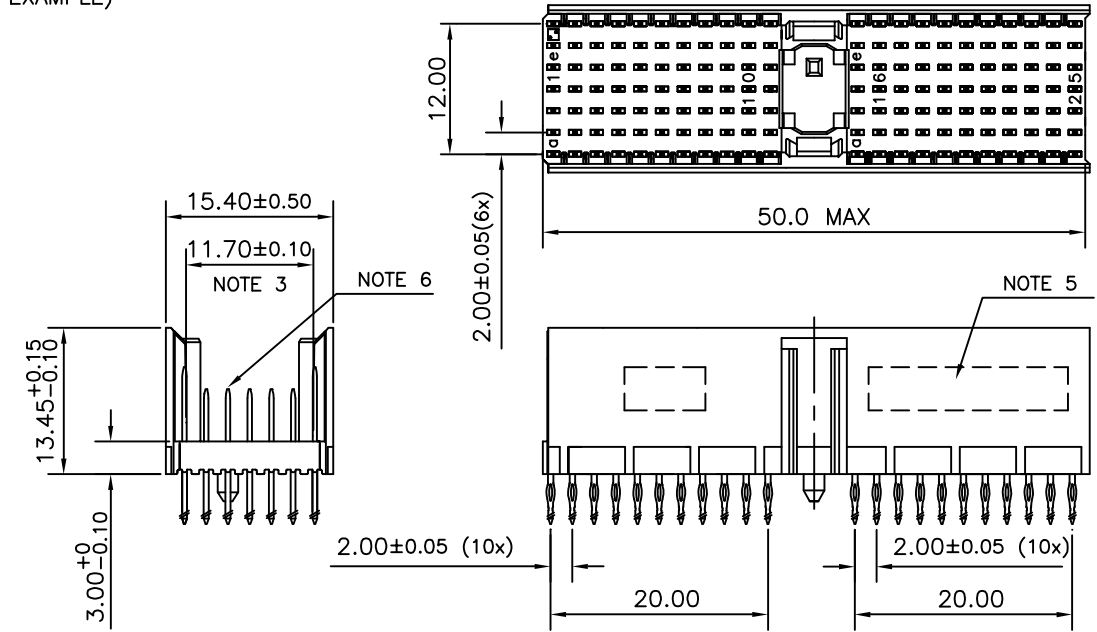

CONTACT OVERVIEW

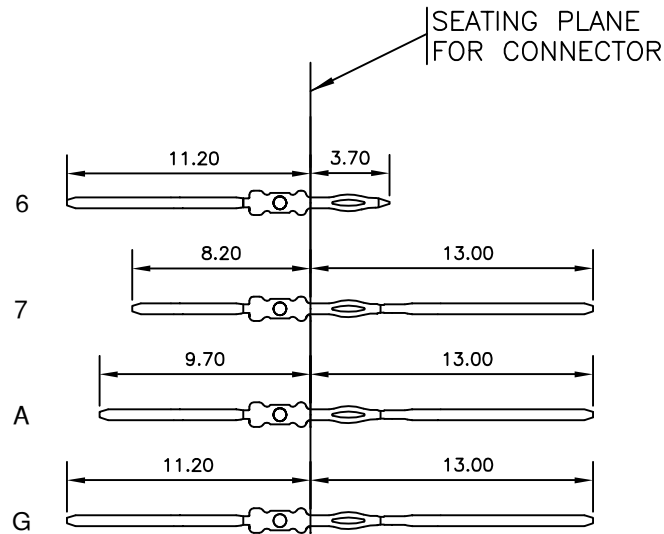

LAY-OUT P.C.B.-HOLE

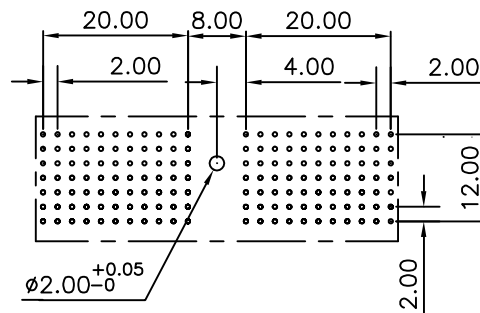

HM2P07PKN124 **LEAD FREE INDICATOR : LF = LEAD FREE (DIGIT 15 & 16)**
PLATING CODE (DIGIT 13 AND 14)
 (REF DRW NO. BS,C , 201844 , 003)

NOTES

- THIS PRODUCT IS CSA APPROVED.
 - THIS PRODUCT IS UL RECOGNIZED.
 - MEASURED AT THE BOTTOM.
 - MATERIAL CONTACT: PHOSPHORBRONZE
 HOUSING: CREAM WHITE GLASS FILLED POLYESTER UL-94V0
 - CONNECTOR PRINTED WITH P/N AND DATE CODE.
 - FOR ACTUAL CONTACT LOADINGS, SEE LOADING PATTERN MATING SIDE.
 - SHAPE OF CONNECTOR HOUSING CAN ALTER DEPENDING ON PRODUCTION LOCATION
 - THE PRODUCT (LF) MEETS EUROPEAN UNION DIRECTIVES AND OTHER COUNTRY REGULATIONS AS DESCRIBED IN GS-22-008
 - FOR RECOMMENDED PTH DIMENSIONS REFER DRAWING : BS, A , 201572 , 001
- CATALOG NO: HM2P07PKN124----

mat'l. code SEE NOTE 4				surface ISO 1302 <input checked="" type="checkbox"/>		tolerance ISO 406 ISO 1101		projection 		product family MILLIPACS					
litr				ecn no		dr		date		tolerances unless otherwise specified					
A				105-0114		MINI		2005-07-12		angles		linear		.0±0.2	
B				106-0099		MINI		2006-07-14		0°±1°		linear		.00±0.1	
										scale		-			
										dr		MINI K VANDANATH		2005-07-12	
										enr		BIJU K PAUL		2005-07-12	
										chr		BIJU K PAUL		2006-07-14	
										appd		BIJU K PAUL		2006-07-14	
sheet index		revision sheet		B		1									